



<b>Type</b>	: <b>PUSHER TERMINAL TUG with CPP</b>	<b>Deck Machinery</b>	Forward: One electro hydraulic windlass/ towing winch with brake force 110 T
<b>Year Built</b>	: 1999	Aft:	One electro hydraulic towing winch with braking capacity 110 T
<b>Port of Registry</b>	: Singapore	Stern roller:	3 m x 0.8 m, SWL 100 T
<b>Class</b>	: ABS A1, Towing vessel, FFV 1, AMS, ACCU	<b>Navigational Equipment</b>	Radar, Gyro, SSB radio, GPS, Auto Pilot, Echo Sounder, Marine VHF, Magnetic Compass, GMDSS: Area 2
<b>Dimensions</b>		<b>External Fire-Fighting Capability</b>	"FIFI 1" Class Two pumps via step up gear box and clutch by main engines Capacity: 2800 m <sup>3</sup> /hr (combined) via two remote controlled monitors of 1200 m <sup>3</sup> /hr each on top of wheelhouse
Length Overall	: 28.17 m	Trajectory Range:	120 m
Length BP	: 28.90 m	Trajectory Height:	65 m
Breadth Moulded	: 9.50 m	Two foam proportioners	
Depth Moulded	: 4.95 m	Self drenching system:	Main deck, Deck house, Wheel house
Draft Design	: 3.80 m	<b>Oil Dispersant System</b>	2 spray booms of 4.5 m each with spray nozzle for concentrate or chemical dispersant
<b>Tonnage</b>		<b>Fire Detection/Extinguishing</b>	Machinery space is fitted with smoke and flame detector protected with a CO <sub>2</sub> total flooding fire extinguishing system
Registered tonnage	: 96 T	<b>Accommodation</b>	10 persons
Gross tonnage	: 319 T	<b>Builder</b>	Odo Shipbuilding and Engineering, Japan
<b>Speed</b>	: 12 knots	<b>Owner</b>	Keppel Smit Towage Pte Ltd
<b>Bollard Pull</b>	: 55 T		
<b>Capacity</b>			
Fuel	: 70 m <sup>3</sup>		
Fresh water	: 15 m <sup>3</sup>		
Foam	: 15 m <sup>3</sup>		
Dispersant	: 18 m <sup>3</sup>		
<b>Main Engine</b>			
Niigata 6L26HLX			
2 x 2,000 bhp at 750 rpm			
<b>Propulsion</b>			
Niigata ZP-31 CP fixed pitch propeller with steerable Azimuth thrusters			
<b>Generator</b>			
Detroit AC Diesel Generator 4-71 T			
2 x 100 kW, 50Hz, 3 phase and 415 volts			

*This vessel specification is given in good faith and assumed to be correct as at 02 July 2019*



**KEPPEL SMIT TOWAGE PTE LTD**



# GENERAL ARRANGEMENT

TUG NAME: KST KANCIL

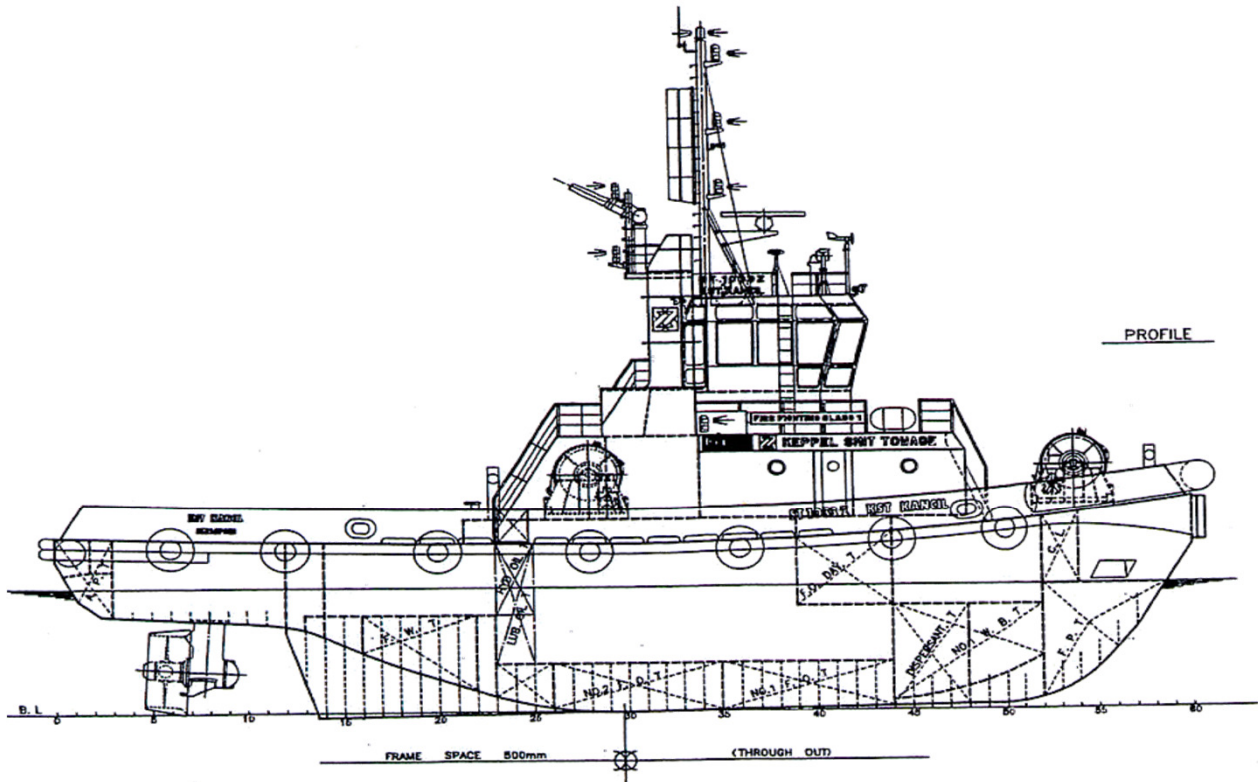

PROFILE

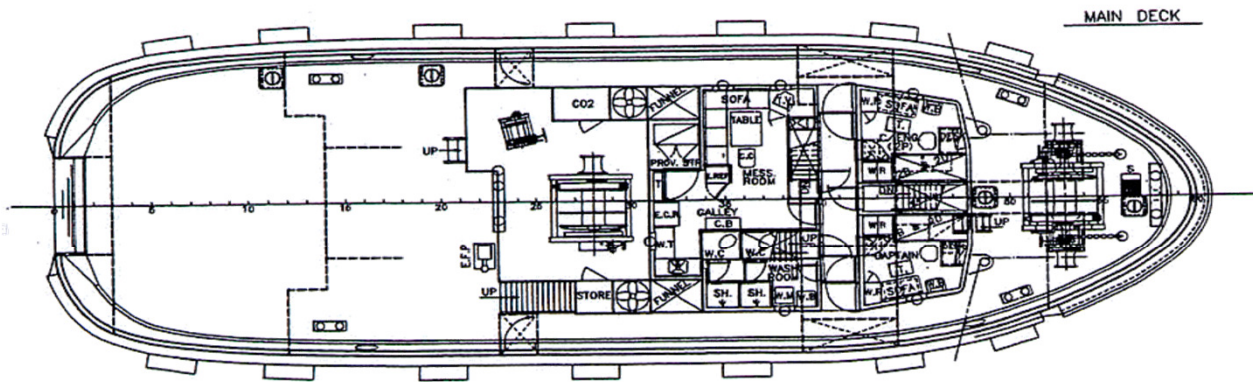

MAIN DECK

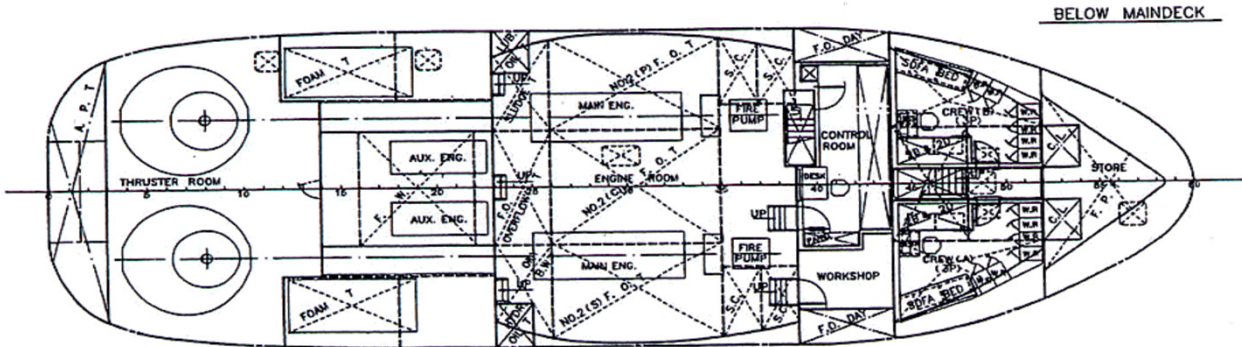

BELOW MAINDECK