



**Type** : **PUSHER HARBOUR TUG**

**Year Built** : 1995

**Port of Registry** : Port Kelang, Malaysia

**Class** : ABS  
✕ 100 A1 Tug ✕ LMC

**Dimensions**

Length Overall : 30.50 m  
Breadth Moulded : 9.60 m  
Depth Moulded : 4.36 m  
Draft Design : 3.55 m

**Tonnage**

Net Tonnage : 95 Tons  
Gross Tonnage : 319 Tons

**Speed** : 12 knots

**Bollard Pull** : 45 T excess

**Capacity**

Fuel Oil : 53 m<sup>3</sup>  
Fresh water : 20 m<sup>3</sup>

**Main Engines**

Yanmar 6Z280A-EN  
2 x 2,000 bhp at 750 rpm

**Propulsion**

2 x Schottel SRP 1212 fixed pitch propeller with steerable Azimuth thrusters

**Generators**

2 x Yanmar 6HAL-TN

**Deck Machinery**

Forward

Plimsoll, electro hydraulic windlass /  
Towing winch  
Braking capacity : 90MT

Aft

Plimsoll, electro hydraulic towing winch  
Braking capacity : 90MT

Tow Hook: Plimsoll, 81T  
Pneumatic quick release

**Navigational & Communication Equipment**

Echo sounder, Marine Radar,  
Magnetic Compass, VHF Radio

**Fire Fighting System**

2 x Engine driven FIFI Pump  
2 x fire monitor  
Water curtain system

**Accommodation**

6 persons

**Builder**

Malaysia Shipyard and Engineering Sdn Bhd

**Owner**

KSP Towage Sdn Bhd

*This vessel specification is given in good faith and assumed to be correct as at 03 July 2019*

## KSP TOWAGE SDN BHD (680765-U)

No. 129-01 & 129-02, Jalan Mutiara Emas 2A, Taman Mount Austin, 81100 Johor Bahru, Johor, Malaysia.

Telephone: +607 364 9070

Fax: +607 364 9362

Email: general@kspkejora.com

# GENERAL ARRANGEMENT

TUG NAME: KSP 43

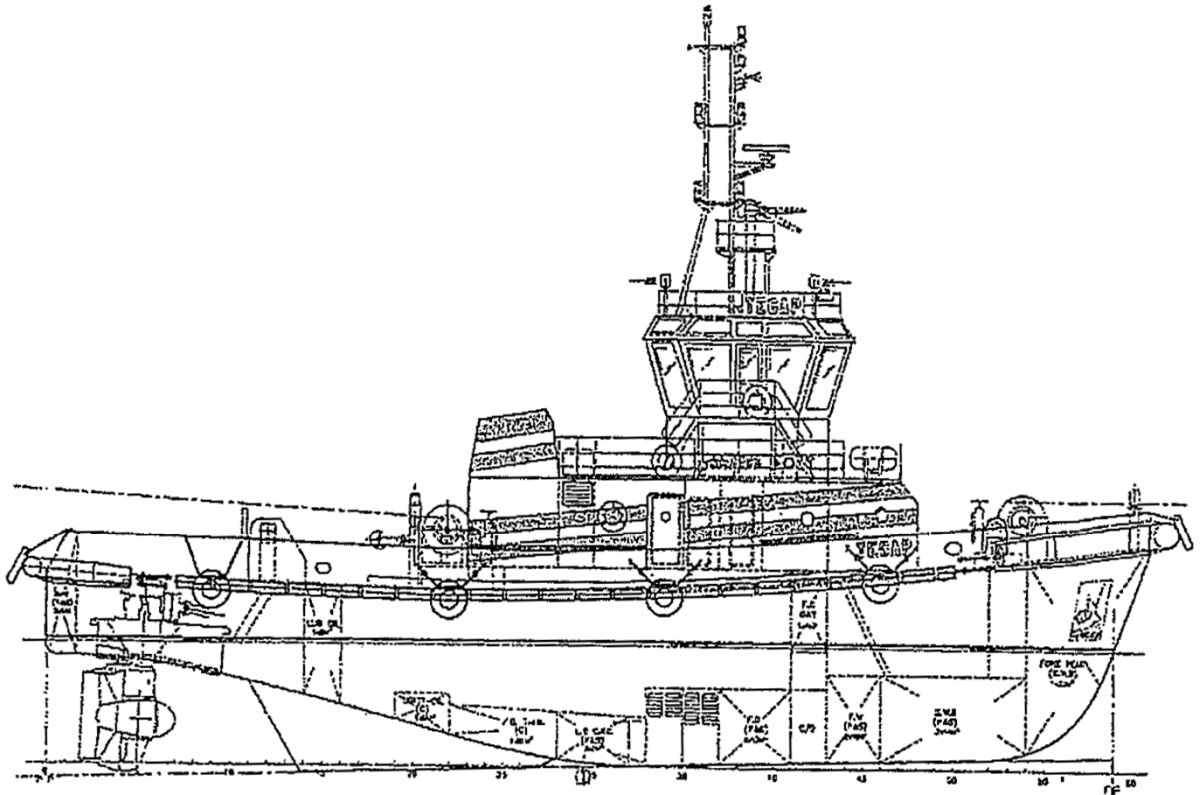

OUTBOARD PROFILE

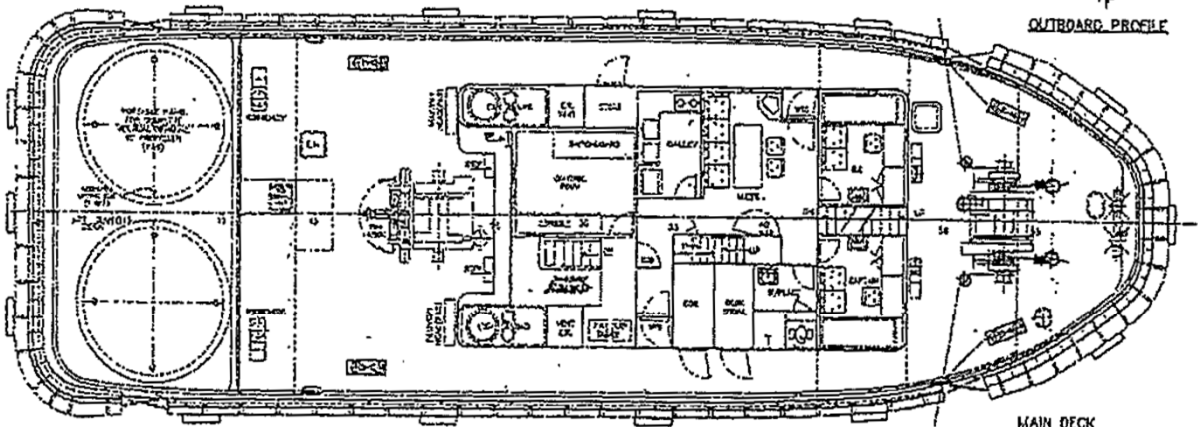

MAIN DECK

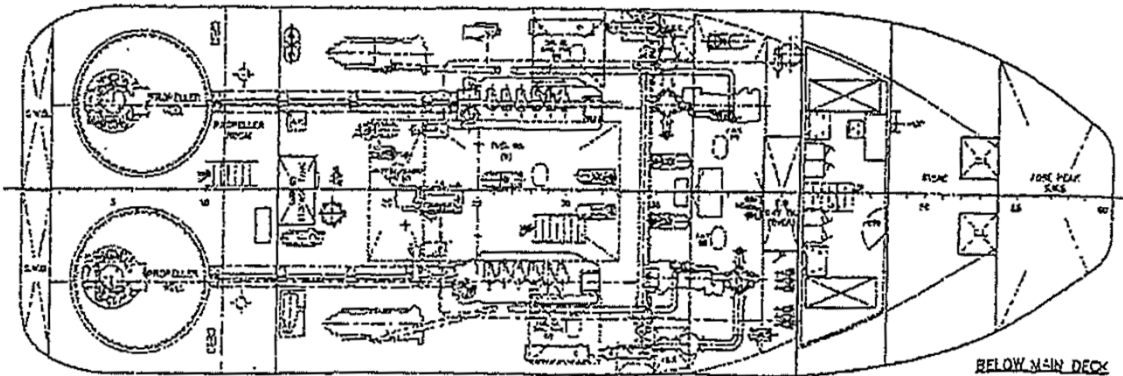

BELOW MAIN DECK